

MOTION NO. 5237

*Just
for
NE Lake
Washington
Council
Rm*

A MOTION authorizing the County Executive to enter into a contract with Northeast Lake Washington Sewer and Water District for a franchise to construct, operate and maintain a sewer system in Council District 1 and 3

WHEREAS, Northeast Lake Washington Sewer and Water District has filed an application in accordance with R.C.W. 36.55.010 for a franchise to construct, maintain and operate a sewer system, and

WHEREAS, the comprehensive plan was approved by Ordinance 4147 on 3/19/79 and Ordinance 4205 on 4/23/79 and

WHEREAS the application has been referred to the County Executive for investigation of the feasibility thereof; and

WHEREAS the County Executive has recommended approval of the franchise.

NOW, THEREFORE, BE IT MOVED by the Council of King County:

The County Executive is hereby authorized to enter into and execute the attached sewer system franchise contract, dated May 22, 1981, in the upper left hand corner, for Northeast Lake Washington Sewer and Water District, which by this reference is incorporated herein as part of the Motion, said franchise is granted to Northeast Lake Washington Sewer and Water District for the term of 18 years. Said franchise to include all of the general and special conditions required by the County.

If within thirty (30) days after the granting of this franchise the applicant shall have failed to sign the incorporated written acceptance herein, then the herein granted rights and privileges shall be forfeited and said franchise shall be null and void.

PASSED this 3rd day of August 1981

KING COUNTY COUNCIL
KING COUNTY, WASHINGTON

Ken Barden
Chairman

ATTEST:

Deborah M. Reusner
DEPUTY Clerk of the Council

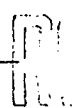

UA5-45-

WATER DISTRICT 81 OF KING COUNTY

May 31, 1983

Mr. Rod Matsuno
Utility Section
Department of Public Works
Room 855 King County Admin. Bldg.
Seattle, WA. 98104

Dear Mr. Matsuno:

Enclosed please find Water District #81's proposal to assume operation and responsibility for the Trend Sewer service area.

We feel we are the logical agency to assume operation of the Trend Sewer area because Water District #81 is a long established utility with years of experience and has always been responsive to its customers in providing high quality of continuous and reliable service to meet domestic needs and fire flow requirements.

The Water District has established high standards for development of the water system that will ensure a very reliable system for its customers for many years. These same standards will apply to the sewer utility.

The Board of Commissioners by Resolution have declared the district's intent to establish a sewer utility to provide comprehensive planning and development of sewers for the unsewered area of the district on the west slope of Rose Hill. The Certificate of Necessity is being prepared for submittal to the Department of Ecology and other appropriate agencies for approval.

The District has initiated this action because the need has been clearly demonstrated and to accomplish systematic development of sewers consideration must be given to comprehensive planning of the entire area at this time. This need has been further demonstrated as a result of

P.O. Box 539 Kirkland, Washington 98033 13013 N.E. 65 ST. 827-0681

ADDENDUM G

Mr. Rod Matsuno
May 26, 1983
Page 2

information provided to us by the King County Health Department showing a greater amount of septic tank failures than we were previously aware of within the proposed planning area. See the enclosed letter and map from King County Health Department.

The Commissioners and staff of the district have met and discussed the matter of sewers with officials of Redmond and Kirkland to negotiate any agreements that may be necessary.

Thank you for your cooperation and assistance. Please contact me at 827-0681 if you need additional information.

Best Regards,



William T. Skahan
General Manager

WTS:TE

Enclosures

KING COUNTY WATER DISTRICT NO. 81

SEWER PROPOSAL

May 26, 1983

1) Rates applied to King County customers could be somewhat reduced from current charges. The Trend customers are presently receiving water from us therefore our administrative costs would be substantially lower than county. An administrative cost per account was determined applying water customer count to 1982 administrative and customer costs. In relating this customer cost to Trend customers we assumed the impact per sewer customer would be 30% of water customers. Operations and maintenance followed the categories set out by county maintenance records. We increased the flushing program to 3 years from 5 years and increased training and safety as some of our personnel have not previously dealt with sewer. Another increase was applied to capital outlay, as we anticipate some minor modifications.

Listed below are some current factors that would affect our rate:

Administrative	1.72
Operations & Maintenance	2.23
Kirkland Wheeling	.40
Debt Payment	<u>1.75</u>
	6.10
Metro	<u>5.35</u>
	11.95

This rate may be affected by an increase from any upcoming or proposed increase that Metro would implement in 1984 or 1985 and our ability to negotiate with the City of Kirkland regarding the current \$3.40 Wheeling Charge. We anticipate the other cost centers of the above rate would be adequate for the years 1984 and 1985.

Capital costs are appropriated with the Districts policy of ULID's funded 100% by ULID assessments. In funding replacement of undersized, obsolete and deteriorated portions of the system our policy has been to have the majority funded by revenues.

2) Proposed Levels of Service

Operations and Maintenance

Flushing	3 year program
Repairs	As required
Complaint Investigation	As required
Alarm System Maintenance	As required
Inspections	Routinely conducted and for new installations
Pump Station	Checked twice weekly and repaired as needed
Engineering	As required
General Maintenance	As required
Safety and Training	Integrated into District policies which are now in effect and being developed

3) Our maintenance standards and frequencies are attached. See Water District No. 81 "Conditions of Service Manual", and "Operations Maintenance and Emergency Response Manual".

4) Facilities to conduct Sewer Service.

Water District No. 81's Office and shop are located on a three acre parcel at 13013 NE 65 St., Kirkland, Washington. Co-located at this site is the 11.2 M.G. reservoir and all District operations at this facility. The improvements consist of the Administrative Building, equipment storage building and a pumping station. The District facilities are adequate for the foreseeable future.

The Water District has the following major equipment:

- 1 - 1981 Chev Citation car with mobile radio
- 1 - 1981 Luv pick-up truck with mobile radio
- 2 - 1976 Chev vans with mobile radio
- 1 - 1977 GMC 5 yd. dump truck
- 1 - 1979 GMC 1 ton flat bed with mobile radio
- 1 - 1969 Ford 1 ton with utility box
- 1 - 1981 580 Case backhoe
- 1 - Air compressor 50 CFM
- 1 - Hydraulic power unit

All miscellaneous equipment necessary for construction and maintenance of water distribution system: i.e. portable pumps, portable generator, hydraulic jackhammer, hydraulic cut-off saw, hydraulic sump pump, arc welder, cutting torch, power mole pipe pusher, man hole air pump.

The District recently acquired a Cado Computer System to handle the District's data management. The system has four C.R.T. work stations and handles all of the District's billing, accounting, word processing, budgeting, inventory controls and payroll. It has the capability of interfacing sewer billing to our current water billing system.

Emergency Response Program.

During an emergency, it is the goal of Water District No. 81 to provide as far as possible, adequate quality of service to all customers within the District. In the event of an emergency, the District's primary objectives are to neutralize life and property endangering conditions, to restore temporarily and finally to restore service completely.

To accomplish these objectives, an employee is on call twenty-four hours a day. During non-working hours, the employee can be contacted by telephone through a telephone answering service. Employee on call also is on pager.

At this point it is the intent of the district to reach an interlocal agreement with the cities of Kirkland and Redmond for rental of those types of equipment needed for sewer maintenance activities that we do not presently own. When we have been able to assess priority needs, we will purchase the necessary items. Examples are: rodder, vactor, water tank, etc. We feel it would be a relatively easy or minor task to meld sewer activities with our water district activities. The geographical location of Trend within Water District No. 81 makes it ideal for sewer service to be provided by the Water District.

5) Enclosed is a copy of the Water District Comprehensive Sewer Plan that was developed and approved; however, it was never implemented. The Sewer Comp Plan is being reviewed for updating of the proposed sewer planning area.

6) The district's bonding capacity for water is reflected in the enclosed Historical Operating Statements. The sewer debt ratio is based on our 1984, 1985 Preliminary Sewer Budget which is also enclosed.

7) We do not foresee any obligations or conditions which may be placed upon current users.

8) We would be able to accept operation of the system as early as September 1, 1983. However, due to county planning time frame projection, the January 1, 1984, transfer date appears to be more realistic.

9) We feel our district is the most logical and effective agency to service sewer to the Trend area. Customers of Trend are already receiving water bills from us, therefore the confusion of transition would be minimal to them and ourselves. One agency serving water and sewer would also simplify customers accessing information and making payments on their combined account. Our routine customer problem and emergency response time would be quicker than other agencies as we are located closest to and our crew is familiar with the service area.

Developers would also benefit with our district servicing Trend. One contact point for specifications, costs and approvals is much easier to deal with than various departments or agencies. Providing several services would give us a better understanding and control of new development in our district consistent with county and city zoning.

Our Water District was formed in 1948 and has developed stringent regulations for developing water systems, and constructing and replacing facilities. The Board of Commissioners of the district has shown its ability to work with an effective legislative response time while maintaining a high standard of regulations.

In recent years we have received many inquiries regarding sewer service. A survey was conducted in March of this year to determine customer response and need for sewers. The survey indicated and the enclosed information from King County Health Department further stressed a real need for sewer service in some areas of our district. On May 10, 1983 the Water District declared by resolution its intent to form a sewer district. We are currently looking at a Comprehensive Plan for sewerage the unincorporated areas within our boundaries that are not presently sewerage. A Certificate of Necessity is also being developed for submittal to the Department of Ecology and other appropriate agencies.

As the intent has been declared, were the District to absorb Trend it would become part of the Sewer Utility for the western slope of Rose Hill.



JESSE W. TAPP, M.D., M.P.H.
Director of Public Health

May 23, 1983

Bill Skahan, General Manager
Water District #81
13013 N.E. 65th
Kirkland, WA 98033

Re: Proposed Sewer Service Annexation Area

Dear Mr. Skahan:

Per your request, enclosed is a map indicating locations where septic system failures have occurred (according to our files). There may be many other failures of which we have no record.

From our experience, the soils in the area are primarily Alderwood series (shallow and frequently with winter water tables) with some smaller areas of Indianola (sand) and Everett (gravels) series.

Very truly yours,

William F. Liening

William F. Liening, R.S.
Supervising Sanitarian
East District Service Center
Environmental Health Section

WFL:BH:k1

Encl.

District Service Centers:

CENTRAL
1500 Public Safety Bldg.
Seattle 98104
625-5536

NORTH
10501 Meridian Ave. N.
Seattle 98133
363-4765

COLUMBIA HEALTH CENTER
3722 Hudson
Seattle 98118
625-5151

SOUTHWEST
10820 8th Ave. S.W.
Seattle 98146
244-6400

EAST
2424 156th Ave. N.E.
Bellevue 98007
885-1278

SOUTHEAST
Renton
3001 N.E. 4th St.
Renton 98056
228-2620

Environmental Health Services
172 20th Ave.
Seattle 98122
625-2763

Auburn
20 Auburn Ave.
Auburn 98002
852-8400

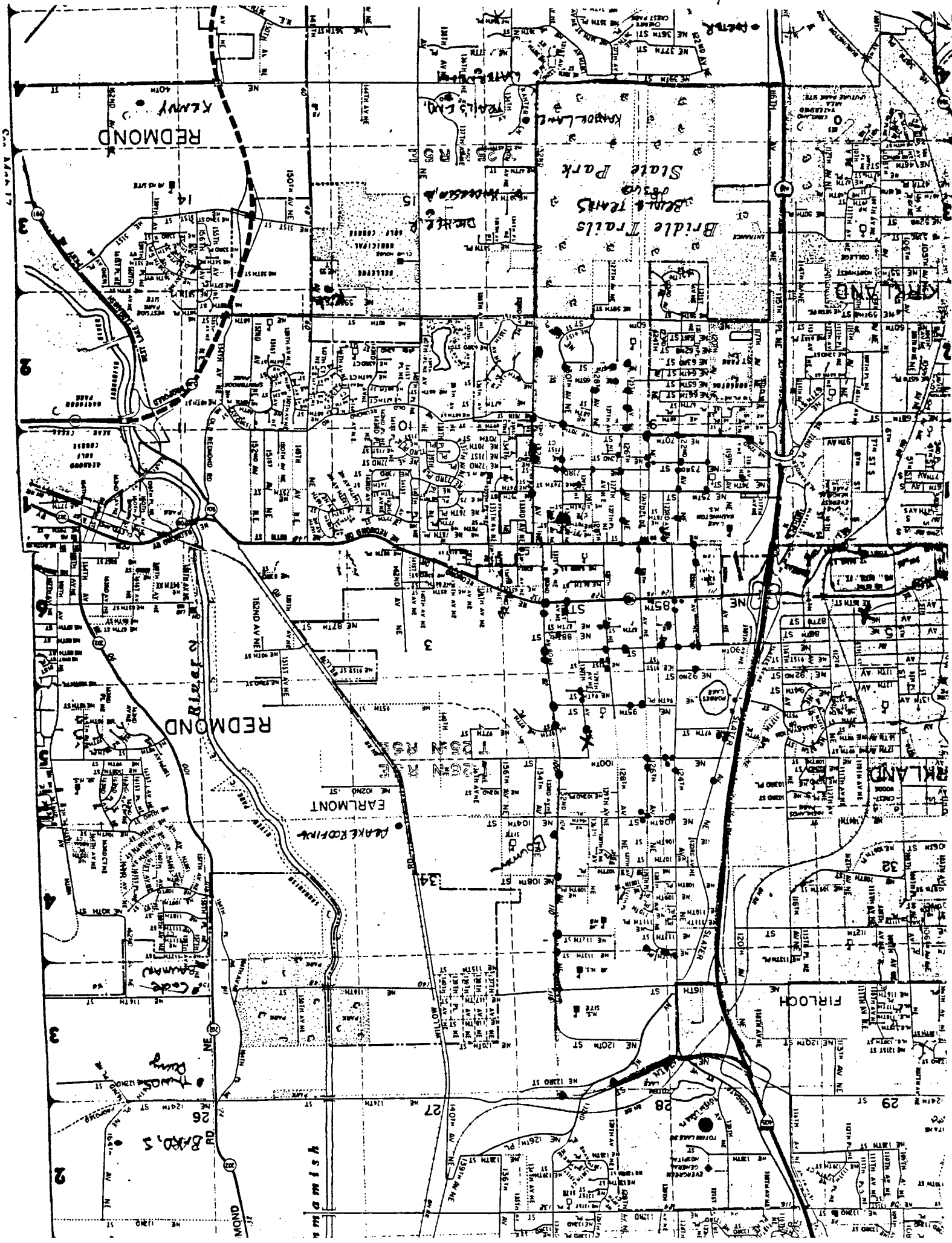

NE 8th
12334
13013

NE 8th
13013

NE 8th
12500
13006

NE 8th
∅

NE 7th

NE 8th
12432

NE 7th
12901

NE 7th
∅

NE 7th
12050
13221

NE 7th
11804

NE 7th
12026 12624 13017
12205 12746 13020

NE 7th
12448 12908
12406

NE 7th
11716 13033
12412

NE 6th

∅
NE 6th

NE 6th

∅
NE 6th

∅
NE 6th

∅
NE 6th
12541

NE 6th

∅
NE 6th

∅

13303
13301
13405
12+13
NE 94th (114-132)

13515
13448
NE 91st

13337
NE 92nd (114-132)

NE 94th (114-132)

13451
13457
NE 95th (122-132)

NE 97th (114-132)

13301
13301
11417
NE 100th (114-132)

NE 102nd (114-132)

13452
13650
NE 104th (114-132)

NE 106th (114-132)

NE 107th (114-132)

NE 108th (114-132)

NE 109th (114-132)

NE 110th (114-132)

NE 111th (114-132)

NE 113th (132-132)

13416
13828
NE 112th (124-132)

NE 120th

NE 123

1

<u>BONE</u>					
4236	4758	8563	9020	9701	11227
4530	8050	8630	9505	10023	
4422	8535	8650	9548	10040	
				10221	

8558
8784

13th NE

13th b
846

8146
8558

8186
8484

8484
8558

13th NE

8320

13th NE

8086
8558

8484
8558

13th NE

∅

13th NE

10001
10001

8086
8558

8484
8558

13th NE

8168
8558

8484
8558

13th NE

15344
11000

8558
8558

8484
8558

13th NE

8558

8484

13th NE

8108

8118

8484

8484
8558
8558

8484
8558

8558
8558

13th NE

∅

13th NE

∅

13th NE

∅

13th NE

∅

13th NE

∅

13th NE

11028

11th AVE NE

∅

13th NE

∅

13th NE

∅

13th NE

∅

13th NE

STOP
 9446 SLATER AVE
 9206 12th NE
 12655 8th
 12221 NE 7th
 11261 SLATER AVE
 13019 NE 6th place
 8049 12th NE
 8746 12th NE
 12724 7th NE
 9051 132nd NE (O.L. Church)
 9726 SLATER
 7746 "

with last year

SLATER AVENUE (42-140)

9435 9746
 4531(81) 10237
 9726
 9735

132nd NE (21-124)

	4530	7535	9505	11227
(420)	4422	8560	9701	
4231	4708	8620	10221	
	9056	9057	10813	

NE 124th (115-132nd)

12734
 13210

NE 116th (115-132)

∅

KING COUNTY WATER DISTRICT NO. 81
HISTORICAL OPERATING STATEMENTS

	<u>1982</u>	<u>1981</u>	<u>1980</u>	<u>1979</u>	<u>1978</u>
<u>Operating Revenues</u>					
Metered Sales	\$ 807,992	\$578,358	\$500,624	\$499,310	\$429,615
Fire Protection	-	-	109	1,056	879
Sales to Public					
Activities	312,276	274,414	233,369	226,317	209,995
Penalties & Misc.	18,615	6,751	4,189	4,987	3,436
Other Operating Rev.	<u>21,289</u>	<u>13,644</u>	<u>15,525</u>	<u>8,589</u>	<u>9,668</u>
Total	\$1,160,172	\$873,167	\$743,816	\$740,259	\$653,593
<u>Operating Expenses</u>					
Water Purchased	\$ 573,263	\$543,915*	\$388,820	\$333,575	\$332,091
Pumping Plant	11,398	7,676	7,153	4,778	2,642
Transmission &					
Distribution	125,744	125,585	94,266	49,717	35,329
Customer Accounts	47,953	45,980	55,490	34,929	28,993
Administration &					
General	<u>279,954</u>	<u>214,397</u>	<u>184,351</u>	<u>169,114</u>	<u>149,108</u>
	1,038,312	937,553	730,080	592,113	548,163
Less Overhead					
Capitalized	<u>(4,488)</u>	<u>(3,070)</u>	<u>(2,012)</u>	<u>(2,111)</u>	<u>(2,478)</u>
Total	\$1,033,824	\$934,483	\$728,068	\$590,002	\$545,685
Net Operating Revenue	\$ 126,348	\$(61,316)	\$ 25,748	\$150,257	\$107,908
<u>Other Income</u>					
Assessment Principal	\$ 12,731	\$ 6,698	\$ 18,973	\$ 23,682	\$ 22,538
Assessment Interest	12,540	7,582	6,695	5,619	736
Interest Income	41,937	48,471	59,612	50,321	35,020
Street Lighting - Net	124	2,603	(1,164)	(230)	769
Miscellaneous	<u>188</u>	<u>754</u>	<u>840</u>	<u>432</u>	<u>834</u>
Total	\$ 67,520	\$ 66,108	\$ 84,956	\$ 79,824	\$ 59,897
Available Debt Service	\$ 193,868	\$ 4,792*	\$110,704	\$230,081	\$167,805
Actual Debt Service	\$ 74,638	\$ 78,050	\$ 81,238	\$ 79,206	\$ 84,438
Coverage	2.60	*	1.36	2.90	1.99

*On December 31, 1980, the District had a total of \$392,870 in all funds. The District elected to use a portion of these funds for debt service and not to raise rates sufficiently to offset the increased cost of water.

KING COUNTY WATER DISTRICT NO. 01

PRELIMINARY SEWER BUDGET

1984 and 1985

May 26, 1983

	Rate at \$11.95
REVENUE	
Sewer Fees	
- Rate \$11.95 (\$28 County)	\$76,719
Inspection Fees	500
Connection Fees	3,150
Late Payment Penalties	649
Operating Revenue	\$81,118
EXPENSES	
Administrative Costs	\$10,060
Operations & Maintenance	12,860
Netro	27,557
Kirkland Wheeling Charge	2,308
Interest	10,500
Subtotal	\$73,785
Inflation 10%	7,379
Subtotal	\$81,164
Net Operating Surplus	(\$ 46)
Plus Assessments Received	20,000
Int on Assess Rec'd	4,250
Less Bond Payment	(20,000)
SURPLUS (DEFICIT)	\$ 4,204
Debt Ratio For Sewer Only	1.61

ADDENDUM H

An easement transfer form is being prepared by Water District 81 and is not yet available for attachment.

